



きたおおじろさんじん
北大路 魯山人

Rosanjin's

PRIVATE EVENT ROOM

**AT RESTAURANT HOSHIGAOKA
THE GRANDSTAND**

THE GRANDSTAND (Former Turf City) | 200 Turf Club Road #01-31
Tel: (65) 6466 3716

FLOOR PLAN

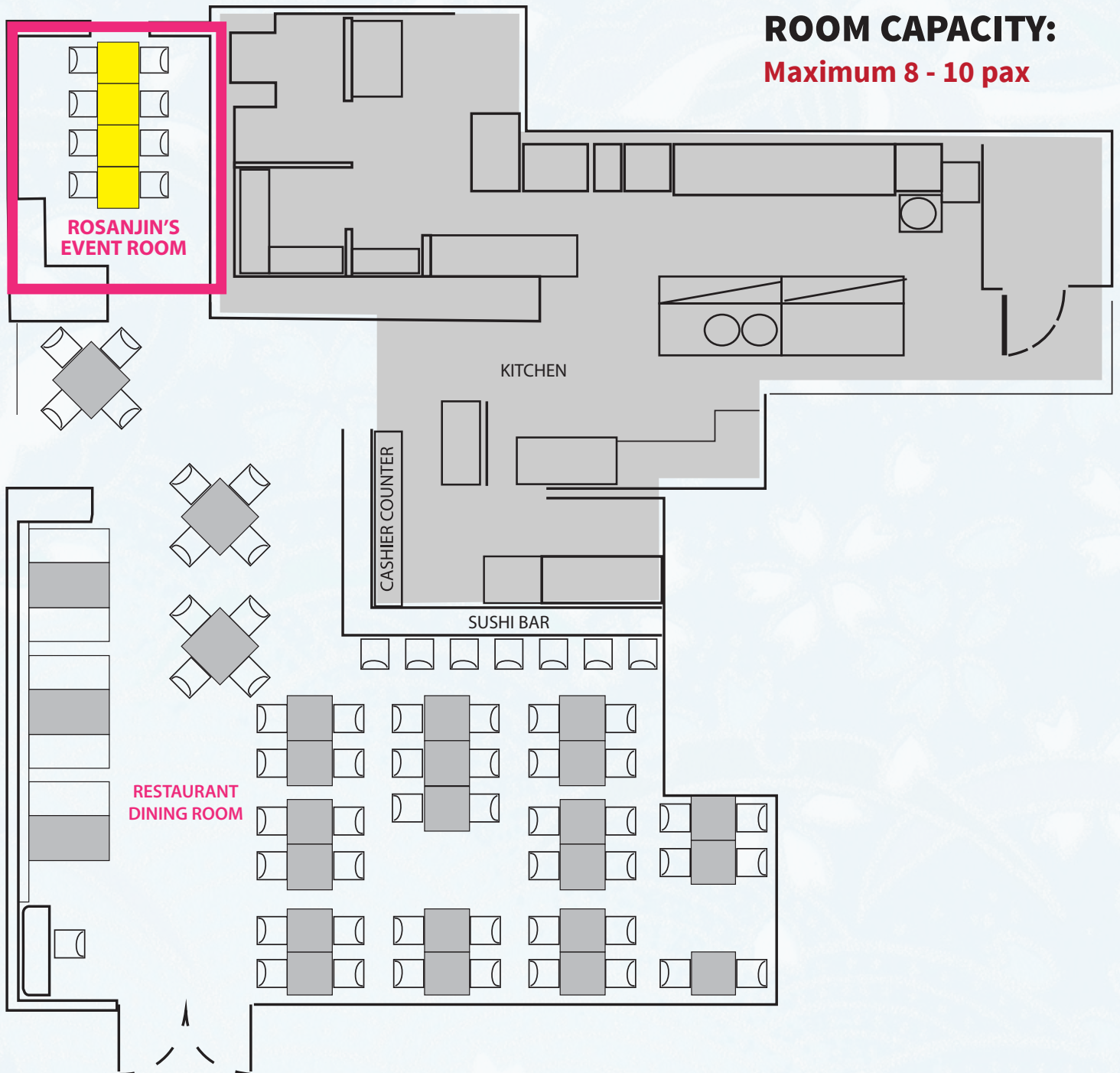

INDOOR DINING

きたおおじろさんじん
北大路 魯山人

Rosanjin's

PRIVATE EVENT ROOM

AT RESTAURANT HOSHIGAOKA
THE GRANDSTAND

SIT DOWN DINING

Maximum 8 - 10 pax



ABOUT US



Jack - +65 8167 6376
function@jppepperdine.com

ADDRESS:

THE GRANDSTAND
(Former Turf Club)
200 Turf Club Road #01-31

CONTACT:

(65) 6466 3716

OPERATION HOURS:

11am - 10pm

SEATING CAPACITY:

Max 8-10pax

AVA CAPABILITIES:

TV

INTERNET CONNECTION:

Free Wifi Available

PARKING:

Free Parking

SHUTTLE BUS SERVICE: (to the Grandstand)

Information extracted from thegrandstand.com.sg

BUKIT TIMAH	CLEMENTI	TOA PAYOH
Sixth Avenue MRT	Clementi MRT King Albert Park MRT	Toa Payoh MRT Botanic Gardens MRT

PRICE RANGE:

Lunch \$150++ min spend
Dinner \$300++ min spend
(GeBIZ mode of payment accepted here)

Lunch Set @ \$20

MIN 8 PAX | MAX 10 PAX

TEPPAN GOMA BEEF

Pan-Fried Beef with Sesame Dressing on Hotplate

OR

SALMON NITSUKE

Salmon in Ginger Soy Broth on Hotplate

SASHIMI MORIAWASE

Assorted Types of Sashimi

TEMPURA MORIAWASE

Assorted Tempura Prawn & Vegetables

Served with
Steamed Rice, Miso Soup, Fruits & Pickles

Dinner Set @ \$30

MIN 8 PAX | MAX 10 PAX

UNAGI KABAYAKI DONBURI

*Grilled Eel with Sweet Soy Sauce
on a Bed of Steamed Rice with Egg*

GYU NIKOMI

Miso Braised Beef

OR

SOOKI NITSUKE

Stewed Soft Pork Bone

SASHIMI MORIAWASE

Assorted Types of Sashimi

TEMPURA MORIAWASE

Assorted Tempura Prawn & Vegetables

**Served with
Chawanmushi, Miso Soup & Fruits**